

# DEORE Front Chainwheel FC-M615

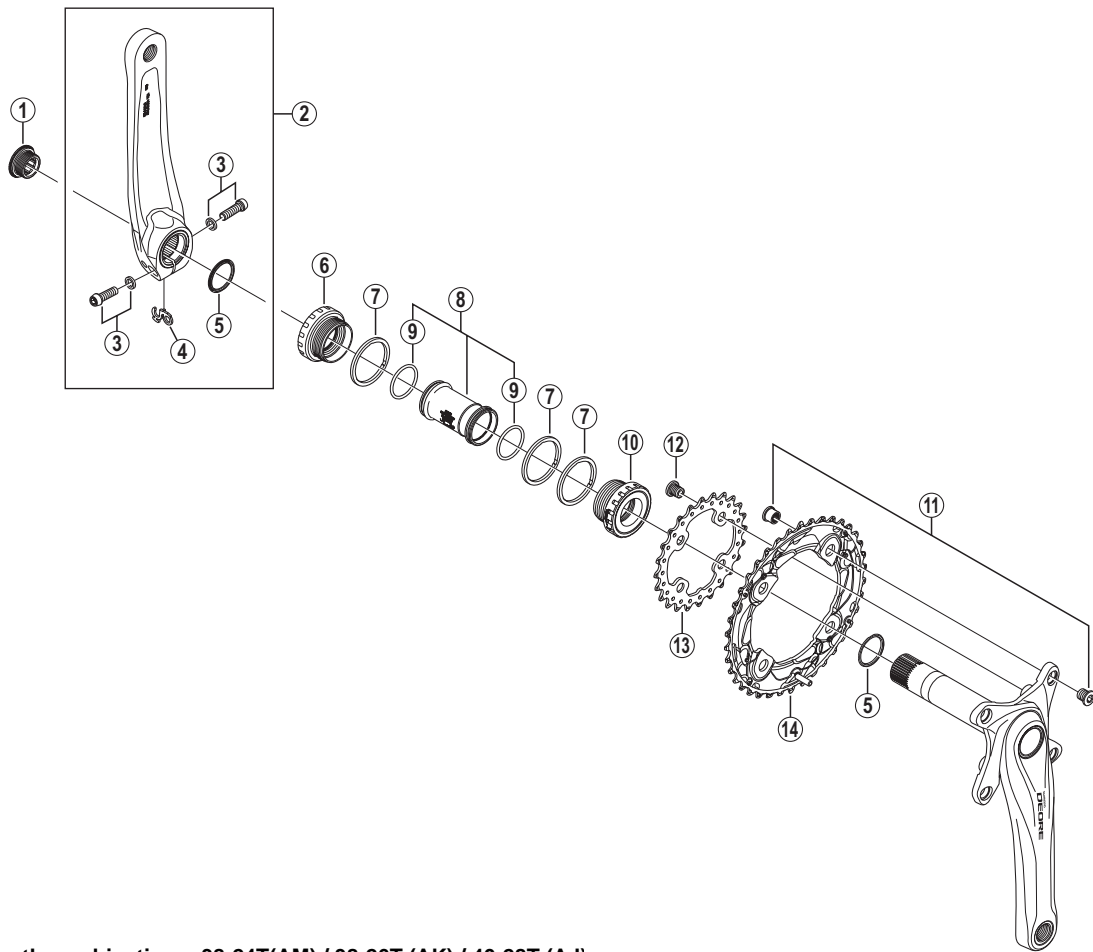

- Chaining teeth combinations: 38-24T(AM) / 38-26T (AK) / 40-28T (AJ)
- Bolt circle diameter: 104 mm...(For outer gear), 64 mm...(For inner gear)

FC-M625

ITEM NO.	SHIMANO CODE NO.	DESCRIPTION	INTERCHANGEABILITY
1	Y1F811100	Crank Arm Fixing Bolt	A
2	Y10098050	Left Hand Crank Arm 170 mm (Silver)	B
	Y10098060	Left Hand Crank Arm 170 mm (Black)	B
	Y10098070	Left Hand Crank Arm 175 mm (Silver)	B
	Y10098080	Left Hand Crank Arm 175 mm (Black)	B
3	Y1KS98030	Clamp Bolt (M6 x 19) & Washer	A
4	Y10011000	Plate Pin	A
5	Y1F316000	Ring	A
6	Y1LD98060	Left Hand Adapter (B.C. 1.37" x 24T) English Thread (SM-BB51)	A
7	Y1F813000	Spacer (2.5 mm)	A
8	Y1J898060	Inner Cover & O-Ring	A
9	Y1TF21000	O-Ring	A
10	Y1LD98070	Right Hand Adapter (B.C. 1.37" x 24T) English Thread (SM-BB51)	A
11	Y1P098040	Outer Gear Fixing Bolt (M8 x 7) & Nut (4 sets)	B
12	Y1LV98060	Inner Gear Fixing Bolt (M8 x 8.5 / 4 pcs.)	B
13	Y1NA24000	Chainring 24T-AM	A
	Y1NA26000	Chainring 26T-AK	
	Y1NA28000	Chainring 28T-AJ	
14	Y1P098010	Chainring 38T-AM	A
	Y1P098020	Chainring 38T-AK	
	Y1P098030	Chainring 40T-AJ	

A: Same parts.

B: Parts are usable, but differ in materials, appearance, finish, size, etc.

Absence of mark indicates non-interchangeability.

Sep.-2013-3505

© Shimano Inc. I

Specifications are subject to change without notice.

# SHIMANO