

# SORA Dual Control Lever ST-R3030-L (3x9-speed)

For Left Hand

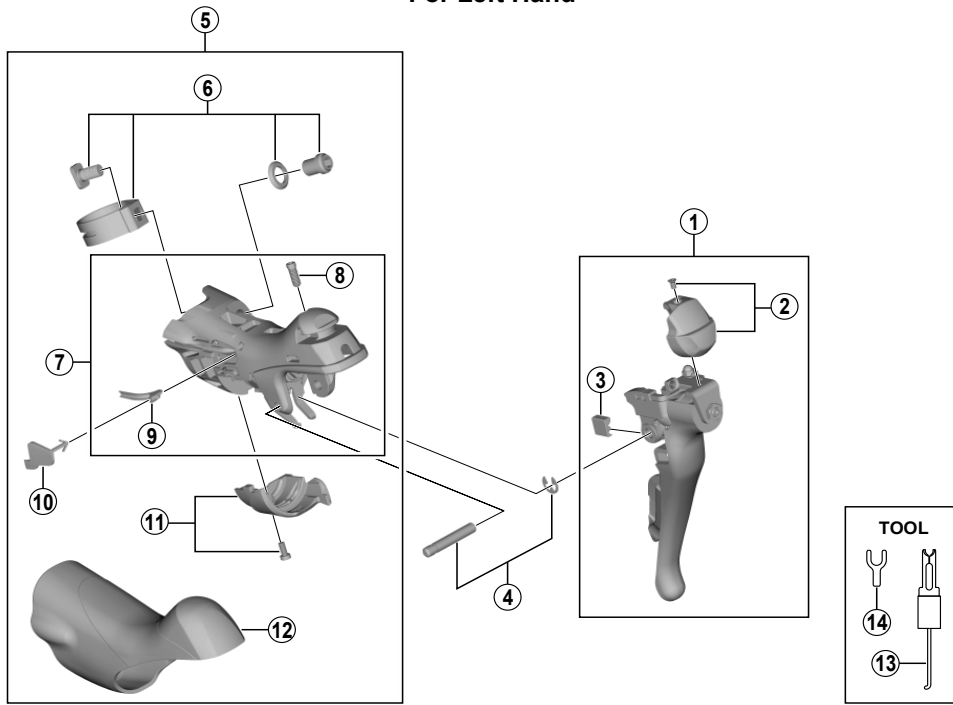

ST-3503

ITEM NO.	SHIMANO CODE NO.	DESCRIPTION	INTERCHANGEABILITY	
1	Y05V98010	L.H. Main Lever Assembly		
2	Y05V98020	L.H. Name Plate L & Fixing Screw		
3	Y05U00100	L.H. Main Lever Support L		
4	Y05T98040	Lever Axle & E-ring		
5	Y05V98030	L.H. Bracket Assembly		
6	Y05T98060	Clamp Band Unit (ø23.8 mm - ø24.2 mm)		
7	Y05V98040	L.H. Bracket Unit		
8	Y05T00170	Grip Adjusting Screw		
9	Y63X55000	L.H. SL Cable Guide L		
10	Y00F75000	L.H. SL Cable Cover L		
11	Y05U98050	L.H. Unit Cover L & Fixing Screw		
12	Y05T98010	Bracket Covers (Black/Pair)		
13	Y6RT68000	Tool A for E-ring	A	
14	Y6RT66000	Tool B for E-ring	A	

A: Same parts.

B: Parts are usable, but differ in materials, appearance, finish, size, etc.

Absence of mark indicates non-interchangeability.

Apr.-2016-4115

© Shimano Inc. I

Specifications are subject to change without notice.

# SHIMANO