

DEORE Front Chainwheel

FC-M532-S Silver Version

FC-M532-L Black Version

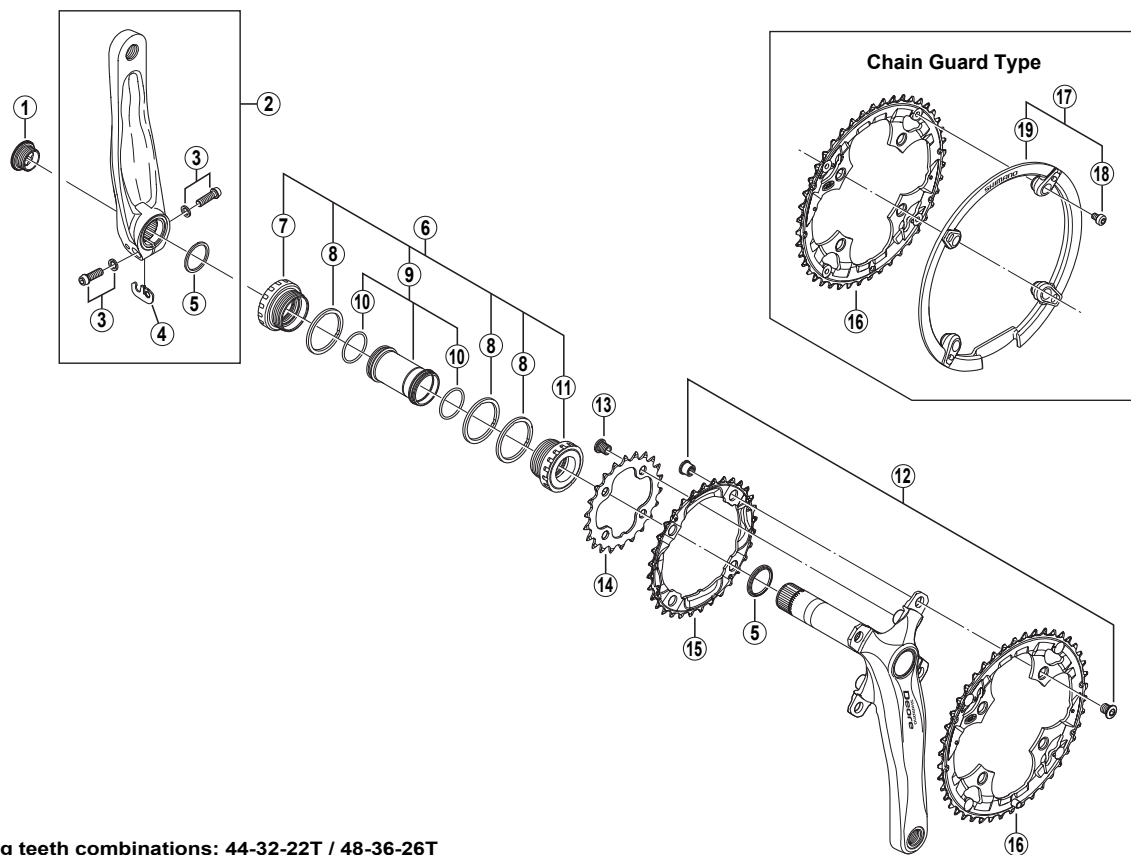

- Chaining teeth combinations: 44-32-22T / 48-36-26T
- Bolt circle diameter: 104 mm...(For outer gear and middle gear), 64 mm...(For inner gear)

ITEM NO.	SHIMANO CODE NO.	DESCRIPTION	INTERCHANGEABILITY	
1	Y-1F8 11100	Crank Arm Fixing Bolt	A	
2	Y-1J8 98010	Left Hand Crank Arm 170 mm (Silver) for FC-M532-S	B	
	Y-1J8 98020	Left Hand Crank Arm 170 mm (Black) for FC-M532-L	B	
	Y-1J8 98030	Left Hand Crank Arm 175 mm (Silver) for FC-M532-S	B	
	Y-1J8 98040	Left Hand Crank Arm 175 mm (Black) for FC-M532-L	B	
3	Y-1G398010	Clamp Bolt (M6 x 19) & Washer	A	
4	Y-1FU98120	Plate	A	
5	Y-1F3 16000	Ring	A	
6	Y-1J8 98050	Adapter Unit	A	
7	Y-1FU98090	Left Hand Adapter (B.C.1.37" x 24T) English Thread	A	
8	Y-1F8 13000	Spacer (2.5 mm)	A	
9	Y-1J8 98060	Inner Cover & O-Ring	A	
10	Y-1TF 21000	O-Ring	A	
11	Y-1FU98100	Right Hand Adapter (B.C.1.37" x 24T) English Thread	A	
12	Y-1FM98020	Double Gear Fixing Bolt (M8 x 8.5) & Nut (4 sets)	A	A
13	Y-1FM98030	Inner Gear Fixing Bolt (M8 x 8.5 / 4 pcs.)	A	
14	Y-1J8 22000	Chainring 22T (Silver)	A	
	Y-1FV 26000	Chainring 26T (Silver)	A	
15	Y-1J8 98070	Chainring 32T (Silver)	B	B
	Y-1J8 98080	Chainring 36T (Silver)	B	B
	Y-1GX98030	Chainring 44T (Silver) for FC-M532-S	B	A
	Y-1GX98040	Chainring 44T (Silver) for FC-M532-S Chain Guard	B	A
16	Y-1GX98050	Chainring 44T (Black) for FC-M532-L	B	A
	Y-1GX98060	Chainring 44T (Black) for FC-M532-L Chain Guard	B	A
	Y-1GX98070	Chainring 48T (Silver) for FC-M532-S	B	A
	Y-1GX98080	Chainring 48T (Silver) for FC-M532-S Chain Guard	B	A
	Y-1GX98090	Chainring 48T (Black) for FC-M532-L	B	A
	Y-1GX98100	Chainring 48T (Black) for FC-M532-L Chain Guard	B	A
17	Y-1J8 98090	Chain Guard for 44T & Fixing Bolts	A	A
	Y-1J8 98100	Chain Guard for 48T & Fixing Bolts	A	A
18	Y-1CY98020	Chain Guard Fixing Bolt (4 pcs.)	A	A
19	Y-1GX14000	Chain Guard for 44T	A	A
	Y-1GY12000	Chain Guard for 48T	A	A

FC-M542

FC-M530

A: Same parts.

B: Parts are usable, but differ in materials, appearance, finish, size, etc.

Absence of mark indicates non-interchangeability.

0706-2679

Specifications are subject to change without notice.

SHIMANO